



## INSTALLATION INSTRUCTIONS

**PART#: SMX-1319L**

**FITS: 2019 - Current RAM 1500**

Thank you for choosing SuspensionMaxx for your vehicle. This kit is designed to add suspension travel and increase front and ground clearance. Specially designed tools and experience are required to complete the installation properly. These parts should only be installed by a qualified mechanic otherwise an unsafe vehicle and/or injury may result. Consult manufactures service manual for proper torque specifications and procedures. Instructions are supplied for the leveling kit installation only. Safety is important. Use safe working habits.

### WARNING!

*This suspension system will enhance off road performance and increase ground clearance. **Larger tires will increase vehicle roll center height.** The vehicle will handle and respond to driver steering and braking differently from a stock factory equipped passenger car or truck. Extreme care must be used to prevent loss of control or vehicle rollover during abrupt maneuvers both on and off-road. Failure to operate this vehicle safely can result in vehicle damage, serious injury or death to the driver and passengers. **Always wear your seat belt and reduce your speed, avoid sharp turns, inclines and abrupt maneuvers.** Tread lightly, respect nature and enjoy the Off-Road Experience! Help keep it available for future generations.*

Thank You!  
SuspensionMAXX Inc.

### REQUIRED TOOLS

- 9/16" Combination wrench
- 9/16" Socket
- 19mm Socket
- Ratchet

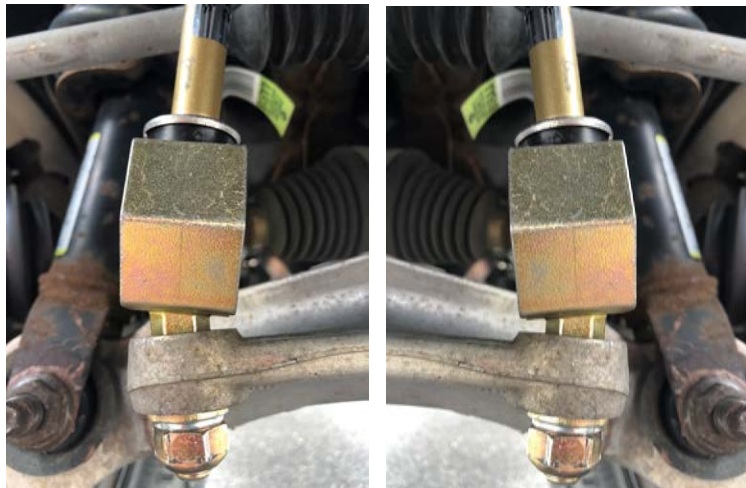

## INSTRUCTIONS

*SuspensionMAXX kits are designed to be easily installed and completely reversible to the factory supplied settings. These instructions are supplied for ease of installation, correct procedures and safety. Automotive experience recommended.*

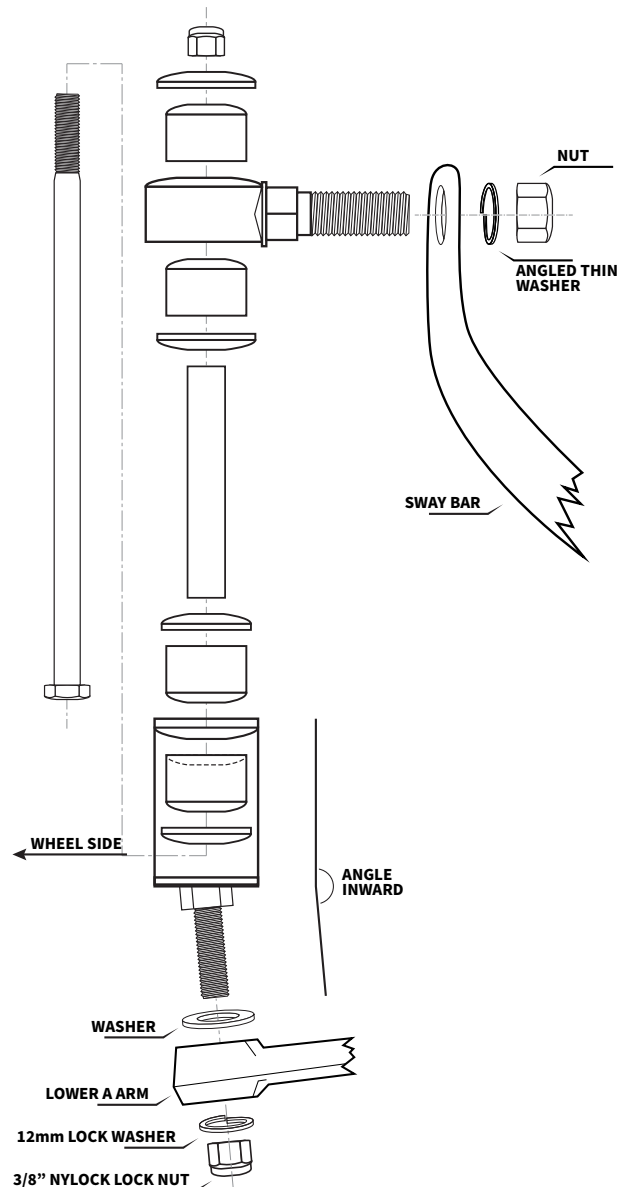

*Again, Thank you for your purchase! Enjoy your SuspensionMAXX leveling system!*

**Questions? E-mail us at [tech@suspensionmaxx.com](mailto:tech@suspensionmaxx.com) or call 1.888.629.9226**



## REQUIRED TOOLS

- 9/16" Combination wrench
- 9/16" Socket
- 19mm Socket
- Ratchet

## STEP 1

1. Unbolt factory sway bar link from lower control arm.
2. Unbolt stabilizer bar from end link
3. With the larger washer slid over the lower end of the stud Insert MAXXLink through lower control arm with 5 degree swivel link end facing outward towards the wheel and hub assembly.

**NOTICE:** The proper alignment of the sway bar end link is important for proper articulation of the end-link.

4. Slide lock washer over lower stud and torque retaining nut on lower control arm to 60 ft/lbs.
5. Pay Close attention to the bushing compression of the sway bar end links. **Over Compression will drastically shorten sway bar link bushing life expectancy and lead to cracking and splitting of the sway bar end link bushings.** The proper compression of the sway bar link vertical bolt is done by simply tightening the vertical bolt **until zero clearance between nut and Stainless Steel washer. Continue to tighten an additional 1.5 turns to set proper busing compression.** If you continue to compress the sway bar links you will notice the lower axle mount bushings will begin to swell growing increasingly larger in diameter. Very little to no bushing compression is ideal. See detailed images bellow as a guide.



Bushing rebuild kits are available at [suspensionmaxx.com](http://suspensionmaxx.com)

- SMX-LRK1

## RECOMMENDED COMPRESSION GUIDE

### OPTIMAL COMPRESSION

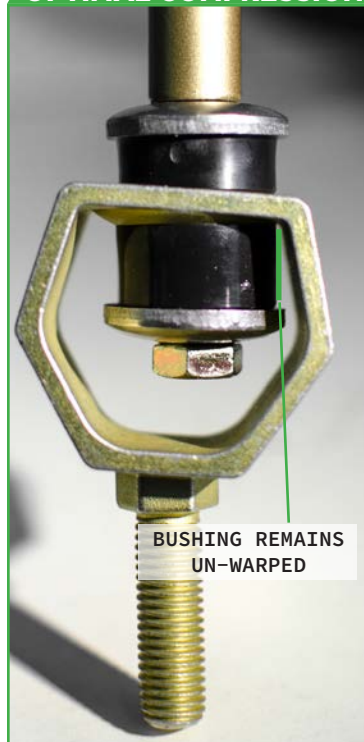

### OVER COMPRESSION

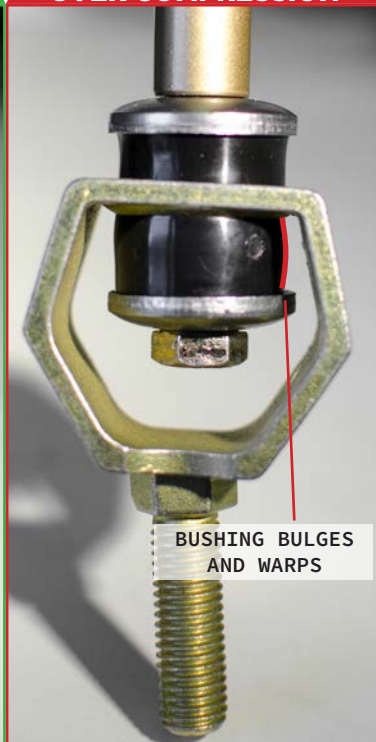

**NOTE:** On OEM applications there should be about 7-9 threads of the bolt showing above the top nut of the MAXXLink.  
FOR ILLUSTRATIVE USE ONLY, IMAGES ABOVE MAY NOT MATCH THIS EXACT PRODUCT

Again, Thank you for your purchase! Enjoy your SuspensionMAXX leveling system!

Questions? E-mail us at [tech@suspensionmaxx.com](mailto:tech@suspensionmaxx.com) or call 1.888.629.9226